



20 Lomond Drive, Wishaw, ML2 0JX
Offers Over £123,000



Spacious and well-presented three-bedroom family home offering generous accommodation throughout. The property benefits from a private driveway, garage, and enclosed gardens, making it an ideal choice for growing families.

Internally, the home features bright and spacious living areas, a well-proportioned kitchen with ample storage and workspace, three good-sized bedrooms, and a convenient ground-floor bathroom. The generous room sizes and practical layout provide excellent flexibility for modern family living.

Externally, the property enjoys private front and rear gardens, a driveway providing off-street parking, and a garage offering additional storage or parking space.

Ideally located close to local amenities, schools, transport links, and motorway networks, this substantial family home is sure to appeal to a wide range of buyers. Early viewing is highly recommended.

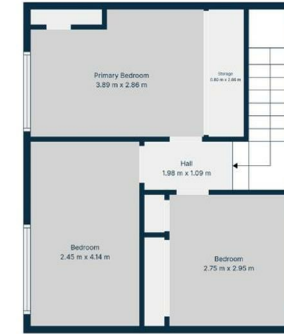

Energy Efficiency Rating		
	Current	Potential
Very energy efficient - lower running costs		
(92 plus) A		
(81-91) B		
(69-80) C		
(55-68) D		
(39-54) E		
(21-38) F		
(1-20) G		
Not energy efficient - higher running costs		
	63	69
EU Directive 2002/91/EC		
Scotland		

Environmental Impact (CO ₂) Rating		
	Current	Potential
Very environmentally friendly - lower CO ₂ emissions		
(92 plus) A		
(81-91) B		
(69-80) C		
(55-68) D		
(39-54) E		
(21-38) F		
(1-20) G		
Not environmentally friendly - higher CO ₂ emissions		
	59	62
EU Directive 2002/91/EC		
Scotland		