



**5 Whittagreen Court, Motherwell, Lanarkshire ML1 5SN**





## 5 Whittagreen Court, Motherwell, Lanarkshire ML1 5SN

Welcome to this charming two-bedroom flat located in the desirable Whittagreen Court, Motherwell. This spacious apartment offers a comfortable living environment, perfect for individuals or small families seeking a modern home.

Upon entering, you will find a well-proportioned reception room that provides an inviting space for relaxation and entertainment. The flat features two generously sized







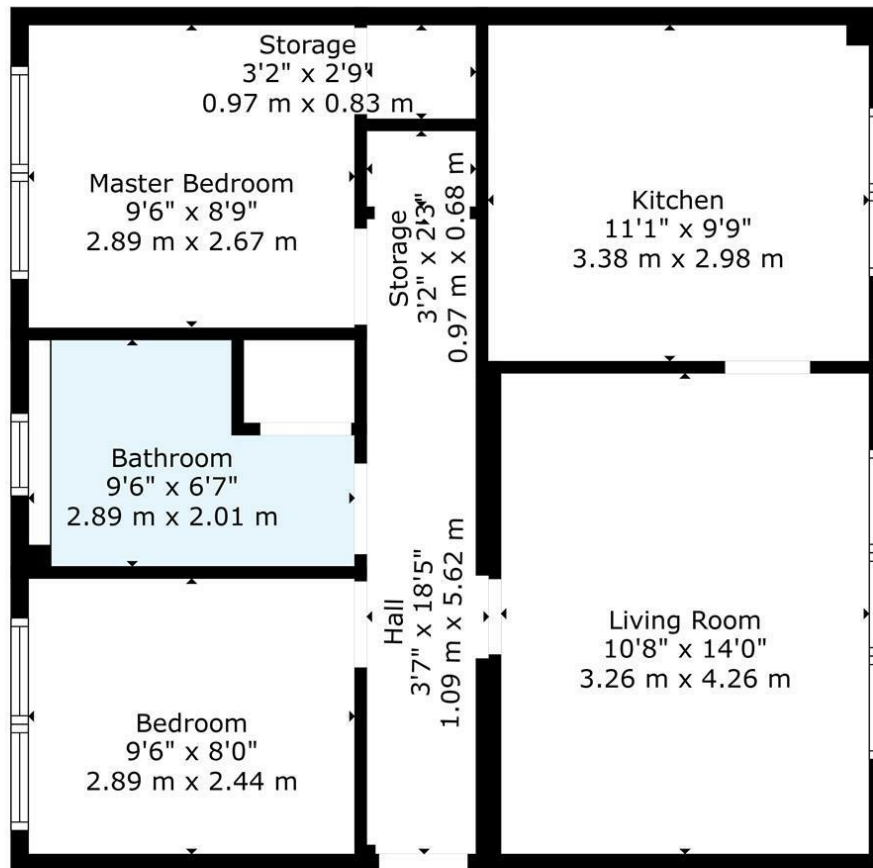

**TOTAL: 571 sq. ft, 53 m2**  
 FLOOR 1: 571 sq. ft, 53 m2  
 EXCLUDED AREAS: STORAGE: 17 sq. ft, 2 m2  
 WALLS: 48 sq. ft, 4 m2

Floor Plan Created By Cubicasa App. Measurements Deemed Highly Reliable But Not Guaranteed.

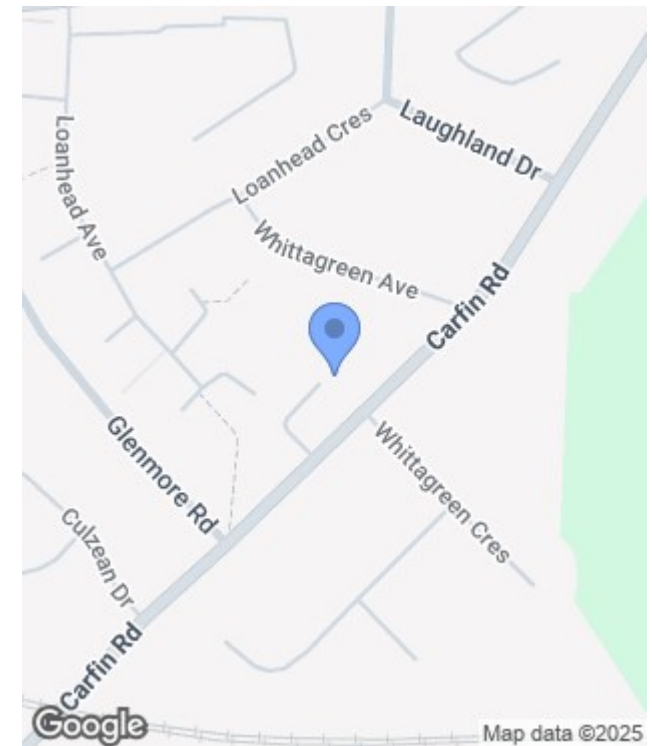

Energy Efficiency Rating		
	Current	Potential
Very energy efficient - lower running costs		
(92 plus) <b>A</b>		
(81-91) <b>B</b>		
(69-80) <b>C</b>		
(55-68) <b>D</b>		
(39-54) <b>E</b>		
(21-38) <b>F</b>		
(1-20) <b>G</b>		
Not energy efficient - higher running costs		
Scotland	EU Directive 2002/91/EC	

Environmental Impact (CO <sub>2</sub> ) Rating		
	Current	Potential
Very environmentally friendly - lower CO <sub>2</sub> emissions		
(92 plus) <b>A</b>		
(81-91) <b>B</b>		
(69-80) <b>C</b>		
(55-68) <b>D</b>		
(39-54) <b>E</b>		
(21-38) <b>F</b>		
(1-20) <b>G</b>		
Not environmentally friendly - higher CO <sub>2</sub> emissions		
Scotland	EU Directive 2002/91/EC	

